

Quick Connectiong Tube Fittings

IPL-M SERIES



Product features

One-Touch tube fittings are used in pneumatics piping.
The tube fittings come in wide variety of models to meet all your needs in pneumatics piping.
Even after installation, in direction of the tube can be changed freely.
Nickel-plated metal body ensures Anti-Corrosion and Anti-Contamination.
All R and NPT threads are Pre-Costed sealant.
All cylindrical threads are standard with O-Ring seals.

Speciality

Fluid	Air, Vacuum
Operating Pressure	0-1.0MPa (150 psi)
Negative Pressure	-100KPa(-29.5 in-Hg)
Max Pressure	1.5MPa
Operating Temperature	0-60°C(32-140°F)
Applicable Tube	Polyurethane and Nylon

Dimensions

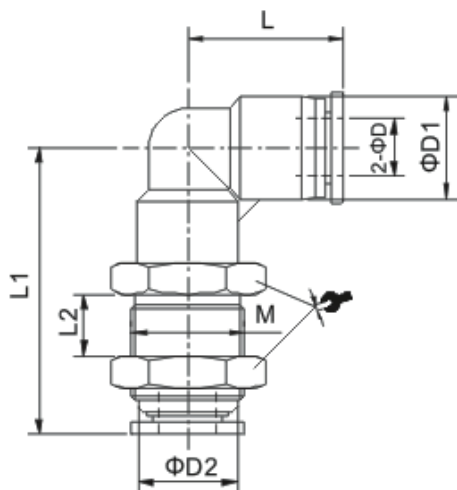

MODEL	ΦD	ΦD1	ΦD2	L	L1	L2	M	
IPLM04	4	11.5	10	19	31	6	M12X1	14
IPLM06	6	13.5	12	19.2	34.5	7	M14X1	17
IPLM08	8	15	14	22.5	41	7.5	M16X1	19
IPLM10	10	19	17	28.5	47	9.5	M20X1	24
IPLM12	12	21.5	20	29.5	49	10	M22X1	26